

**Farms and Cottages in the West Sussex Landscape
Property Record Sheet**

Natural region: Coastal Plain
Parish: Broadwater
Settlement: Worthing

Location of

Property

Not Known

Description of Land Parcel:
 Described as a Yeoman in his probate inventory, John Kempe's overall TEV of £194.14s.0d reflects his elevated status in the early 17th century community at Worthing. Although the location of his farm is not known it was extensive, as in addition to the croft in which his house was located he also farmed 48 acres of arable land.

Occupier: John Kempe
Date: 15th April 1612
Occupation/Status: Yeoman

Probate Inventory Ref: EP1/29/029/002 **Total Estate Value [TEV]** £ 198.394
Appraisers: John Gearinge, Thomas Monke, Thomas Campion, and John Ellyot

Analysis of Goods and Chattels

Description	Household Goods	Livestock	Crops	Stored Produce	Husbandry Tackle	Tools of Trade	Fishing Equipment	Clothes & Money	Debts & Bonds	Land	Other/Misc
In the hall											
1 table, one fframe, 5 joined stools, 2 painted cloths & a bench mat & 1 cushion	1.000										
1 cubbord & a cobbard clothe	1.333										
In the Chamber											
1 joyned bedsted, 1 featherbed, 2 feather bosters, 2 blankets, 1 coverlet, A strawbed, 2 pellowes, curtains & curtaine roodes.	5.833										
2 cobbards, 1 little table & 1 chest	0.900										
In the Lofte over the halle											
1 bedstead, 1 feather bed, 2 feather bolsters, 2 pellowes, 1 blanket, one coverlet, 1 strawbed, a bed mat & The painted cloths	3.333										
1 trucklebed, 1 feather bed, 2 feather boulders, 1 blanket, 1 coverlet and & bed mat	2.000										
3 clothes & one pox p'sed at	0.250										
In the lofte over ye Chamber											
1 bedstead, 1 feather bed, 2 feather bolsters, 2 blankets, 1 coverlet, 1 bed..... & bed mat	2.000										
1 other bedsted, 1 fflockbed, 2 fflock bolsters, 1 blanket, 2 coverlets	0.800										
2 chests, a joined forme & a chair	0.163										
1 old bedsted, 1 chafbed, 1 flock boolster, 1 blanket & a coverlet	0.500										

**Farms and Cottages in the West Sussex Landscape
Property Record Sheet**

Description	Household Goods	Livestock	Crops	Stored Produce	Husbandry Tackle	Tools of Trade	Fishing Equipment	Clothes & Money	Debts & Bonds	Land	Other/ Misc
11paier of towen sheets	0.500										
12 paier of hempe sheets	3.500										
2 hemp table clothes & 2 towen table clothes	0.500										
2 holland sheets, 2 paier of holland pillow coats, 10 napkins, 1 towel & a cobbard clothe	1.500										
2 peeces of new Linon clothe	1.450										
new woollen clothe	1.800										
In the chitchen											
1 malte vate, 3 keelers, 1 brewing tube, 1 baking tub & other old tubs & drinking vessels	1.500										
1 trough, 1 quarne & fower buckets	0.350										
1 table, 2 shelves and a coope	1.000										
6 kettles, 3 brass pootes, a ffurness, 2 chaffing dishes, 2 postnets, a mortar, 2 skemers, a brass ladle & a bed pane.	3.000										
2 spyttes, 2 andirones, 1 fier pane, 1 paier of tongs, 1 oven pylle, 1 wafer iron, pot hangers, pot hooks & a gridiron	0.500										
In the bakehouse											
1 kneading trough, 1 stan, 1 bulthingutch, 1 Bootles with other lumber	0.333										
18 dishes, 2 wooden platers, 12 trenchers, 1 Tankard, 2 candlesticks & a bread grate	1.000										
In the milkehouse											
16 troughs, two spoons, 2 butter tubs, 6 hookes, 1 old fry pan, 8 shelves and tallow	1.000										
12 platters, 9 puter dishes, 2 salts, 2 candlesticks & a Wyne pot, 12 spoons	1.800										
two silver spoons	0.500										
3 qtrs of wheat - p'sed at				5.333							
12 qtrs of barlie				13.000							
3 nayle of hemp				0.200							
butter, cheese & grease	0.250										
one planke	0.025										
hempseede				0.400							
9 sacks, a winshett, 2 half bushels, sives, a paire of stockyards & an old frier						0.800					
2 turns, 3 vorkes, 2 rakes, a wim, a howe: 2 tankards, a press, hookes & keep hookes						0.400					
2 bz (bushels) of salte	0.133										
5 hooges of bacon	3.333										
the horse gear						0.100					

**Farms and Cottages in the West Sussex Landscape
Property Record Sheet**

Description	Household Goods	Livestock	Crops	Stored Produce	Husbandry Tackle	Tools of Trade	Fishing Equipment	Clothes & Money	Debts & Bonds	Land	Other/ Misc
3 iron wedges & other old iron					0.333						
26 acres of wheat p'sed at			30.000								
12 ackers of tares			6.000								
63 sheep		12.000									
2 horses & 2 cootes		4.667									
8 kyne & 2 calves		16.000									
3 younge beaste		2.500									
A beaste of fower years to come		27.000									
8 hoggs & pigges		4.000									
20 lames		2.000									
2 gease		0.150									
6 henes & a cooke		0.175									
2 ton & halfe of timber											1.250
2 cartes, 2 pair of wheels, 2 dunpotes, 2 ploughs, 3 harrows, a rowler & all harness & otherthings					5.000						
100 palles					0.500						
One hundred and a halfe of postes & Raylles					0.600						
3 dossen of wattles					3.300						
fyer wood	2.000										
5 rackes, one manager, 3 ladders					0.500						
1 grine stone, 3 hooge traces & well bucket					0.200						
a paier of curates, 1 lolbeard & a sword	0.900										
A shop with other Sea crafte beames							8.000				
							0.500				
money in his purse								2.000			
Debts owing									3.000		
his apparrell								3.000			
things out of syght											0.5
Total(s)	44.986	68.492	36.000	18.933	11.733	-	8.500	5.000	3.000	-	1.750
% of TEV	22.68%	34.52%	18.15%	9.54%	5.91%	0.00%	4.28%	2.52%	1.51%	0.00%	0.88%

Farms and Cottages in the West Sussex Landscape Property Record Sheet

Description of house and lifestyle

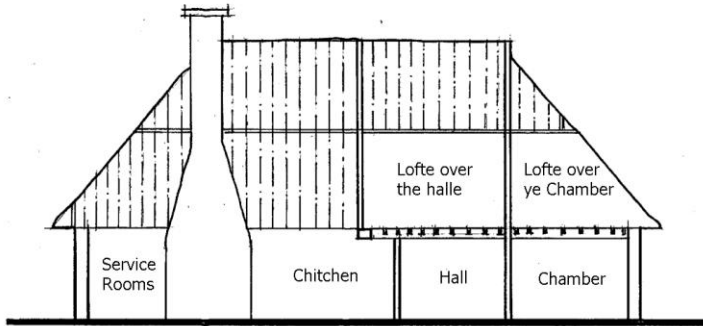

Longitudinal Section

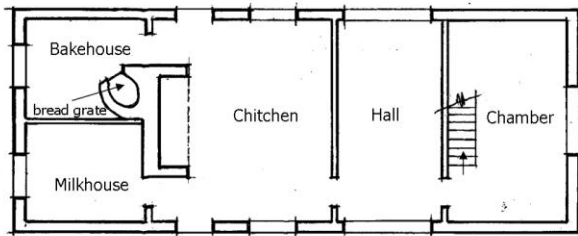

Plan

The house in which John Kempe lived prior to his death in 1612 was a modified 3 bay medieval open-hall house, which when first constructed comprised chamber, hall and service rooms. A brick chimney stack had been inserted in the former cross-passage serving a hearth in a separate kitchen area and a bread grate in the bakehouse, which had enabled additional floorspace to be created at first-floor level.

It is clearly evident from the extent and description of his household goods and chattels appraised at nearly £45 (22.68% of his TEV) that when compared to the widows who still lived in two roomed medieval open-hall houses his life and that of his family was much more pleasant. Their home was much warmer from the heat that radiated from the inserted chimney, and it was relatively smoke free. They slept on feather beds with "Holland" sheets and in winter his bed was warmed by a bed-pan. They brewed their own beer and baked their own bread on the bread grate in the Bakehouse, which they ate in the hall with the butter and cheese produced in the Milkhouse, or ham cut from the fitches of bacon.

His wealth was clearly generated by his farming activities which represented 68% of his T.E.V. and his participation in the fishing industry.

John Kempe's status in the settlement at Worthing is evident from the bequest he made in his will, [WSRO: S.Dean 49] namely that 5s.0d be distributed to the poor people of Worthing and Broadwater on the day of his burial by the overseers, John Gearing and Thomas Monke. He left 20s to his married sister's children when they reached lawful age, and £10 to his daughter Anne when she reached the age of 18 or married. He bequethed "all his wearing apparell, except his best cloak to his brother Thomas Kempe and " one ewe lamb" to his apprentice John Swifte.

John Kempe also left £20 to his grandson, John Harwood (the son of his daughter Mary), to be paid within one year of his death. It would appear this money was never paid as the Probate Inventory of John Harwood (WSRO: Ep1/29/029/011) dated 3rd October 1614 reveals that the money was still in the hands of Edward and Elizabeth Kent, presumably his guardians.

What is more intriguing are the bequests made to his daughter Mary and his wife Elizabeth. He left his daughter Mary, "All my free holde and lease land lying in Worthinge" and £30 to be paid within one year of his death. His wife Elizabeth only received the residue of his goods both movable and non movable not shown nor bequested, after all expenses had been paid", which implies the farm land was separated from the house in which Elizabeth continued to live, devoid of any income to pay for its upkeep.